

# CODE ALARM w/Holder

## WITH NURSE CALL INTERFACE

### TAMPER-PROOF

**Can Be Used with Bed Pad, Chair Pad  
and Seat Belt**

**Model # SCA-1 • Made in China**

**NOTE:**

For resident and patient safety  
& to make this alarm as tamper-  
resistant as possible you must  
press and release the TEST/RESET  
button 3 times within 1.5 seconds  
to stop the alarm  
from sounding.

**PLEASE NOTE: THE CODE TO TURN THE ALARM SOUND OFF ON THIS ALARM HAS BEEN PRE-PROGRAMMED AT THE FACTORY. THE CODE FOR THIS ALARM IS:**

**2 - 3 - 1** (This code is printed on the inside of the battery cover.)

**AS A RESIDENT-PROOF SAFETY FEATURE THE ALARM SOUND ON THIS ALARM CAN ONLY BE SHUT OFF BY PRESSING THE CODE BUTTONS ON THE FRONT OF THE ALARM IN THE NUMBER SEQUENCE ABOVE.**

## FINALLY, A NOISELESS, RESIDENT-PROOF FALL MONITORING ALARM!

### OPERATING INSTRUCTIONS:

1. Remove screw on resident-proof battery compartment cover on front of alarm. Open battery cover by pushing down and out in the direction of the arrow on battery cover. Cover will remain attached to alarm. Insert three "AAA" batteries included in package. **PLEASE NOTE: Alarm will immediately sound once the batteries are installed. To shut alarm off enter pre-programmed shut-off code of 2-3-1. Alarm will immediately stop sounding.** Slide battery compartment cover back in place. Tighten tamper-proof screw. Make certain cover is securely in place.

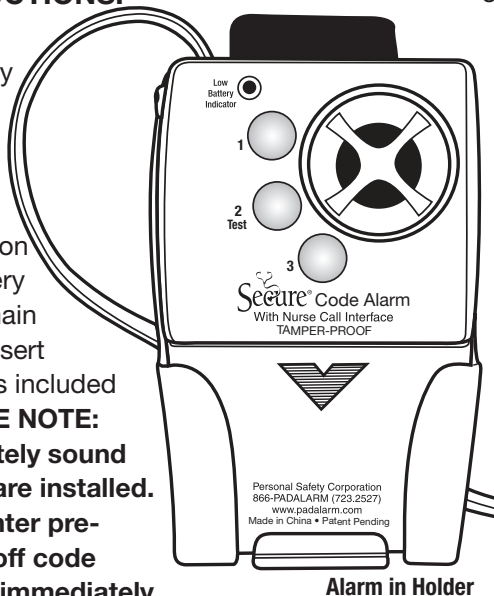

Alarm in Holder

3. Use the end of a pen to move switches marked 2-Volume, 3-Tempo and 4-Tone to test each function and make your setting decisions.
  - a. Switch 2 – Volume switch to desired decibel level. The decibel range is from a high of 90 decibels with the switch in the down position to a low of 70 decibels with the switch in the up position.
  - b. Switch 3 – Tempo switch to the desired tempo from quick in the down position to slow in the up position.
  - c. Switch 4 – Tone switch to the desired tone from a low pitched alarm sound in the down position to a high pitched alarm sound in the up position.

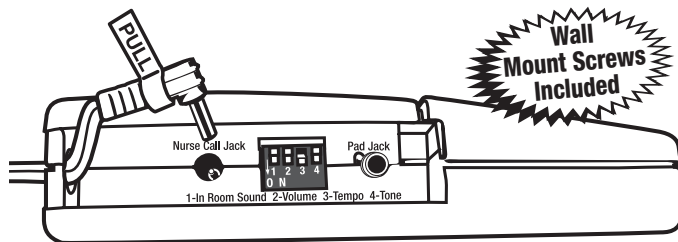

Illustration A

2. On side of alarm loosen locking security screw and slide tamper-proof cover off alarm. To begin making your setting decisions leave all four settings switches in the down position. **Note: Leave switch 1 - In Room Sound switch in the down or "ON" position while testing the other three settings.** Press the button marked "2" on the front of the alarm. The alarm will sound to allow you to make your setting decisions. **Note: The alarm will sound continuously while you are making your setting decisions. If you wish to temporarily stop the alarm sound at any time while making your setting decisions simply press and hold down the "2" button. The alarm will immediately sound again each time you release the "2" button.**
4. To shut the alarm off after making your setting decisions enter the pre-programmed code of 2-3-1 by pressing the numbered code buttons on the front of the alarm in 2-3-1 sequence. The alarm will shut off and automatically reset. **PLEASE NOTE: The pre-programmed code 2-3-1 is embossed in the alarm casing under the battery cover in the event the code is forgotten by a staff member.**
5. If using a nurse call cable determine if you want to silence the alarm in the resident's room. If you want the alarm to sound ONLY at the nurse's station and DO NOT want the alarm to sound in the resident's room when using the nurse call feature, move the switch marked 1-In Room Sound up to the "OFF" position. If you want the alarm to sound in BOTH the room and at the nurse's station slide the switch down to the "ON" position.

*continued*

**PLEASE NOTE: IF YOU DECIDE TO SILENCE THE ALARM IN THE RESIDENT'S ROOM WHEN USING THE NURSE CALL SYSTEM, YOU MUST SLIDE THE 1- IN ROOM SOUND SWITCH UP TO THE "OFF" POSITION. IF YOU WANT THE ALARM TO SOUND IN THE RESIDENT'S ROOM THE NEXT TIME USED YOU MUST MOVE THE IN ROOM SOUND SWITCH DOWN TO THE "ON" POSITION.**

6. To use nurse call interface slide nurse call wire down into open slot at the end of alarm and plug metal jack into opening marked "Nurse Call." Tuck "Pull" tabs into settings compartment. See illustration A.
7. Slide connecting wire of pad through open slot at end of alarm on top of the nurse call wire and plug metal pin into opening marked "Pad Jack." Tuck "Pull" tabs into setting compartment. Slide both the nurse call and pad connecting wires through the open slot at end of alarm. Note: Whenever you want to remove either the nurse call and/or the pad wires pull up on the tabs marked "Pull" and remove the connecting wires from the end of the alarm. **CAUTION! ALWAYS remove sensor pad pin from alarm by pulling straight up on the white "PULL" tab. DO NOT attempt to remove pin any other way or you may damage pin and void warranty.**
8. Slide alarm's patient-proof cover back into place and tighten the locking security screw.
9. Place alarm into holder included. Press alarm's back firmly against holder to secure Velcro pieces. When it is necessary to remove the alarm from holder simply pull up on the alarm.
10. Affix the alarm and holder securely to the side of the bed or chair out of sight and reach of the resident. Simply

wrap the Velcro strap with the rubberized not-slip backing attached to the back of the holder tightly around railing or frame of bed or wheelchair. **CAUTION: Do not affix alarm to a PVC rail. The strap may permanently stain the rail.** Holder placement should be easily accessible to staff. Secure excess cord to avoid damaging cord.

11. If using the nurse call interface connect the standard 1/4" nurse call wall jack into wall outlet for your nurse call system in the resident's room. Check to make certain your nurse call system is functioning properly.
12. Press down on the # 2 button on the front of the alarm to test alarm. The alarm will sound continuously until you enter the 2-3-1 resident proof safety code in sequence using the numbered buttons on the front of the alarm. The alarm sound will shut off and the alarm will automatically reset.
13. Place resident so that resident's buttocks or shoulder are in the center of the bed or chair pad. When resident is placed on the pad the alarm will automatically be set to sound if the resident attempts to exit the bed or chair.
14. The red "Low Battery Indicator" light will come on when it is time to change the batteries.
- 15. NEVER ASSUME! TEST EACH TIME THIS SYSTEM IS USED.**

---

**WARRANTY:** Personal Safety Corporation warrants this product to be free from factory defects in materials and workmanship for a period of one year from the date of purchase. Warranty is void if this product is misused, abused or damaged. No warranty or responsibility of use expressed or implied.

---

## CAUTION!

**This product is not a restraint. It will not prevent a resident from getting out of their bed or chair.  
This product is designed as a monitor, alerting the staff when the resident has risen from their bed or chair.  
This product is to be used in conjunction with a total fall prevention program**



**Secure® Hip Protectors - SHP**  
(In five sizes)

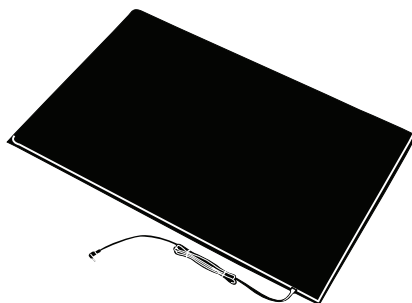

**Secure® Reversible Safety Floor Mat - MAT-1 & MAT-2**

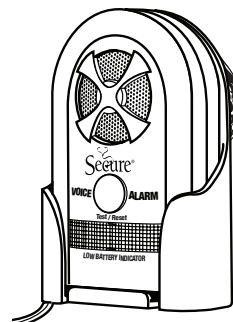

**Secure® Voice Alarm SVA-1**



**Secure® Universal Alarm SUA-1**



*Please see our complete line of Secure® fall/wandering prevention & patient safety products at [www.SecureSafetySolutions.com](http://www.SecureSafetySolutions.com)*

**Highest Quality...Lowest Prices...Guaranteed!**

**Personal Safety Corporation • Hiawatha, Iowa 52233 • 800.373.2873**